

[Download Brochure](#) | [Inquiry](#) | [Registration Online](#) | [Download Registration Form](#)



Go to [SketchUp.edu.my](http://SketchUp.edu.my) website for more tutorials and samples.



Go to [SketchUp Facebook](#) and like us.

**Up Coming Course**

**RM1060**

\*Price quoted is inclusive of 6% GST

**Date: To be Advised**

**Time: 10am-5pm**

**Duration: 3 Days /18 Hours**

**Venue 1: Bandar Puteri Puchong, Selangor, Malaysia**

**Venue 2: Plaza Mahkota, Melaka, Malaysia**

### Why SketchUp?

**SketchUp** is an easy-to-learn 3D modeling program that enables you to explore the world in 3D. With just a few simple tools, you can create 3D models of houses, sheds, decks, home additions, woodworking projects - even space ships. And once you've built your models, you can place them in **Google Earth**, post them to the **3D Warehouse**, or print hard copies.

Moreover, why pay for expensive CAD software, if you can get free **SketchUp, Google Earth, 3D Warehouse** from Google now!

|                     |                     |
|---------------------|---------------------|
| <b>3D WAREHOUSE</b> | <b>GOOGLE EARTH</b> |
|---------------------|---------------------|

The new 3D Warehouse is a feature of SketchUp that lets you search, share, and store 3D models. Anyone may search and download models or submit your own.

Want to know more about a specific location? Dive right in — Google Earth combines satellite imagery, maps and the power of Google Search to put the world's geographic information at your fingertips.

The features of SketchUp:-

**Simple & Fast**

SketchUp has a unique interface that allows 3D forms to be created, viewed and modified quickly and easily. It allows you to draw in 3D space, just as you would use a pencil and paper.

**Push/Pull Tool**

Push/Pull, as the name implies, enables you just to click on a shape and push or pull it to create 3D geometry. It allows you to create complex forms quickly and efficiently.

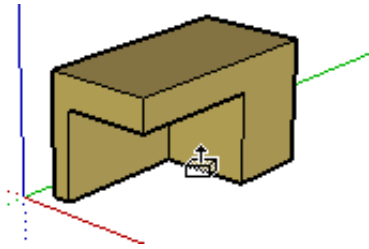

### Sketchy Rendering

SketchUp's real-time renderer let's you visually soften your drawings with rendering effects like jitter lines, extended edges and dynamic profiles.

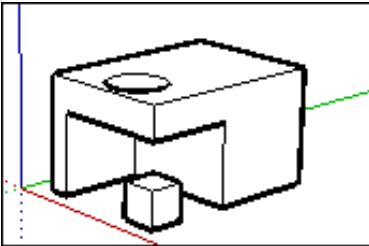

### Real-time Shadows

SketchUp's real-time shadow casting engine let's you see exactly where the sun falls in your model.

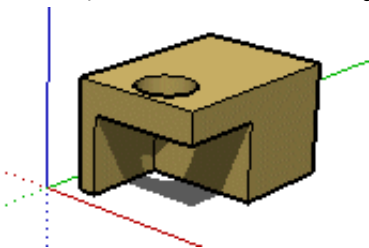

### Material Exploration

Use SketchUp to experiment with color and texture interactively and directly on your model.

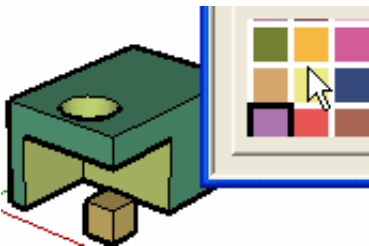

### Interactive Sections

SketchUp's Section Tool allows you to place cutting planes interactively, and to move them around dynamically. The section views of your model can be exported to any supported file format.

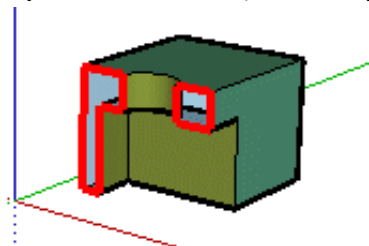

### Versatile Component Architecture

Quickly organize geometry for convenient selection, while keeping it isolated from other lines and faces in your model. You can double-click access to any geometry you want to edit, without having to explode or redefine them.

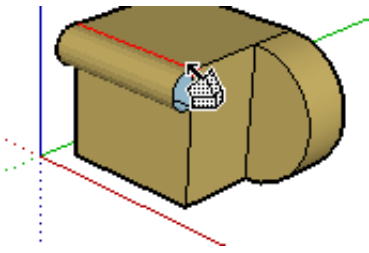

### Dimensions and Annotation

Design for the real world requires accurate communication, so SketchUp gives you a simple but powerful set of tools to pull out dynamic dimension strings as you work.

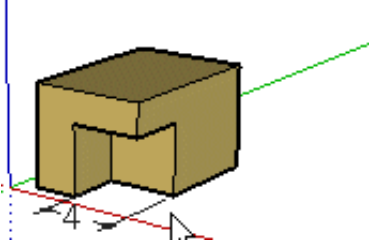

### Presentation Animations

TourGuide Technology allows you to create dynamic slideshows animations of your models just by saving specific views. Animations now can be created in a matter of minutes and not hours.

### Imports and Exports

With SketchUp, you can import a DWG/DXF file and also exports to DWG/DXF, 3DS, VRML, PDF, EPS, JPG, TIF, and PNG.

## For Who

We welcome anyone who are interested with SketchUp and fans from various industries :-

### Architecture

SketchUp was built on the philosophy that a small, powerful toolset that did it's best to capture the spirit of drawing, would be the most effective way of enabling designers to expre



### Construction

When bidding on a remodel, measure the existing structure and useSketchUp to quickly create an accurate 3D model. By digitally present the design, client will fully understands the end result

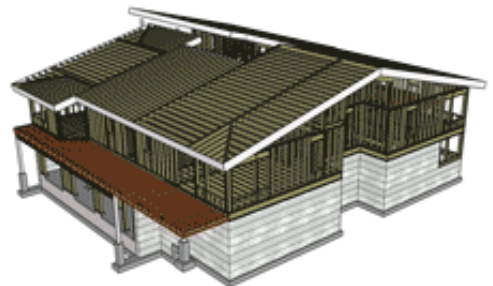

### Interior Design

SketchUp helps to:

- Generate space plans
- Interior & exterior shadow studies
- Real time color composition & analysis



## Landscape Architecture

Use SketchUp for an in- depth analysis of the site's views, features and topography. SketchUp models tend to look more like hand-drawn sketches than final drawings. Many firms are now using it to generate an under layer for these types of sketches.



## Geographic Information Systems (GIS)

- Create walking/flying tours of the models
- Model an existing neighborhood and Look out the window to analyze line of sight, street exposure
- Shadow Studies
- Main Street Studies

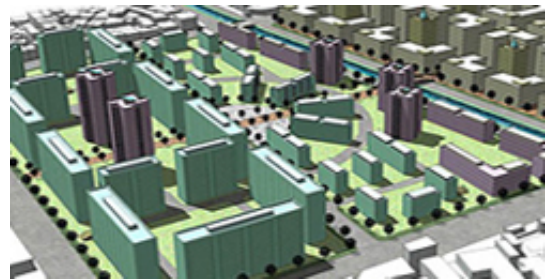

## Mechanical Design

Inm SketchUp, the new powerful tools like 'The Intersector', has the ability to do Boolean-like modeling.

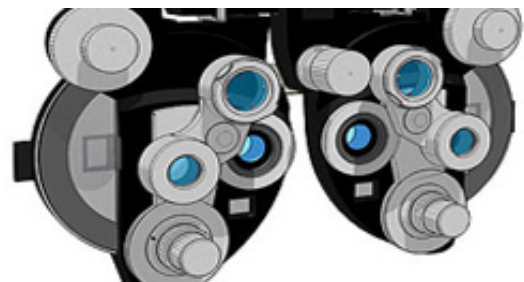

## What will you learn?

You will be introduced with the SkethUp, 3D Warehouse and Google Earth. Exploring how to create 3d model, render and do walkthrough to the 3d model. Followed by, exploring how to download 3D models from 3D Warehouse and share your 3D models with others.

## Course Content

### Chapter 1 - Introduction To Sketchup Chapter 7 - Camera Tools

Designing in SketchUp  
Drawing Quickly

Previous  
Standard Views  
Orbit Tool

Viewing Models in 3 Dimensions  
 Adding Detail to Your Models  
 Presenting Your Models  
 Modeling Terrain and Organic Shapes

Pan Tool  
 Zoom Tool  
 Zoom Window Tool

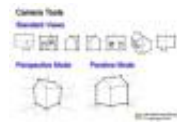

**Chapter 2 - Application User Interface** **Chapter 8 - Walkthrough Tools**

Title Bar  
 Menus  
 Toolbars  
 Drawing Area  
 Status Bar

Position Camera Tool  
 Walk Tool  
 Look Around Tool

**Chapter 3 - Principal Tools**

Select Tool  
 Eraser Tool  
 Paint Bucket Tool

**Chapter 9 - Rendering Tools**

Face Style  
 Soft Smooth Edge  
 Section



**Chapter 4 - Drawing Tools**

Line Tool  
 Arc Tool  
 Freehand Tool  
 Rectangle Tool  
 Circle Tool  
 Polygon Tool

**Chapter 10 - Model Settings And Managers**

Model Info Dialog Box  
 Entity Info Dialog Box  
 Material Browser  
 Material Editor  
 Component Browser  
 Layer Manager  
 Page Manager  
 Display Settings Dialog Box  
 Shadow Settings Dialog Box  
 Soften Edges Dialog Box  
 Component Outliner  
 Application Preferences Dialog Box





## Chapter 5 - Modification Tools

Move Tool  
Rotate Tool  
Scale Tool  
Push/Pull Tool  
Follow Me Tool  
Offset Tool  
Intersect With Model Tool  
Position Texture Tool

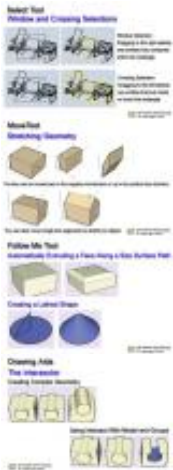

## Chapter 11 - 3D Warehouse

Search for SD models stored in the 3D Warehouse  
Download the 3D models from 3D Warehouse  
Upload 3D models into the 3D Warehouse

## Chapter 6 - Construction Tools

Tape Measure Tool  
Protractor Tool  
Axes Tool  
Dimensions Tool  
Text Tool  
Section Plane Tool

## Chapter 12 - Google Earth

# Workshop Projects

**With the guidance from Instructor, Participant will be doing Hand-On exercise to create Architectural, Interior Design, Construction, Mechanical or related drawing based on Participant's industry background.**

# Course Instructor

**Mr Liang Ee Hang** specializes in training, software customization, support & service project (for animation, drafting, documentation). He has more than ten years experience in CAD/CAM industry. He possesses advanced CAD/CAM skills in SketchUp, Artlantis Render, DesignWorkshop, AutoCAD, and etc.

He has experience in conducting AutoCAD training for various industries, to name some of the companies: Infineon Technologies (M) Sdn Bhd, Melaka, Chunghwa Picture Tubes (M) Sdn Bhd, Shah Alam, Chip Ngai Engineering Works Sdn. Bhd., Jeks Engineering Sdn Bhd, Multi Discovery Sdn Bhd, Cycleworld Corporation Sdn. Bhd, Weng Meng Industries Sdn Bhd etc.

# What will you receive?

You will be given:-

1. **A Manual of SketchUp Workshop**
2. **A CD which includes the following items:-**
  - SketchUp (FOC) \*



**Pusat Latihan Komputer Cempaka**  
~Your HRDC Premiere Training Provider~

**Call Cemtech now at 03-80684461 or 06-2835955 to reserve a seat(s) for the above course!**

**All course fees are 100% claimable from PSMB-HRDF!**

**Any inquiry please [click here](#). Registration online, please [click here](#).**

Newsletter generated by,

**Cempaka Technology Sdn Bhd**



**Head Office:**

1-28, Jalan PM4, Plaza Mahkota,  
Bandar Hilir,  
75000 **Melaka**.  
Tel: 06-2835955 Fax: 06-2845955

**Branch:**

64-2, Jalan Puteri 2/2,  
Bandar Puteri Puchong,  
47100 **Puchong**, Selangor.  
Tel: 03-80684461 Fax: 03-80684240

Website: <http://www.cemtech.edu.my>